



ON THE **BROADS**

WITH
A
BROOM
BOAT





INTRODUCTORY

Our boatyard, part of which is shown in the busy panoramic view above, is beautifully situated in the lovely upper reaches of the River Yare, and for those to whom crowded roads are best avoided, Brundall Railway Station is adjacent.

For 60 years we have been building craft for visitors' use when cruising on the Broads. We build them for private owners as well. With some modesty we may say that some of the best craft built on the Broads have come off our stocks. We state this to assure you that if you select one of our cruisers for your holiday, you may be certain that she is soundly built and in first-class condition, clean, well supplied with linen, china and cutlery, and comfortable. In the pages that follow you will find detailed descriptions and illustrations of our fleet.

As a member of Blakes Norfolk & Suffolk Broads Yacht Owners' Association, we would stress the service that visitors to the Broads secure from hiring craft belonging to members of that Association. Its flag flies over the members' boatyards.

Free water, moorings and a fresh supply of ice for your ice box are available there. If mechanical trouble occurs, assistance is readily given. There is an interchange of service and courtesy that is of inestimable value to the sum total of holiday happiness.

As with all Association craft our fleet is guaranteed to meet the Association's standard of safeguards.

C. J. Broom & Sons
Boatbuilders & Marine Engineers
Brundall, Norwich, Norfolk, NOR 86Z
Tel: BRUNDALL 2334 & 2253

Established 60 years

CRUISING ON THE BROADS

Navigating a Broads motor cruiser brings an incomparable thrill. Smooth power, sensitive response to your hand on the wheel! Knowledge of driving a car helps the beginner but is not necessary. No driving licence is required, nor is previous experience essential. Motor cruising is a unique joy open to ALL.

Our experienced staff explain all the controls when you take over the boat and give an instructive trial run. Our advice is freely available and we spare no effort to ensure you feel confident before leaving the boatyard.

For every member of the party, a Broads motor cruiser has unique attractions as a holiday headquarters. The decks and well are ideal for lounging in the sun, yet your privacy on board is complete, especially down below in the beautifully equipped cabins.

The cabins are roomy and airy, with 6 ft. or more of headroom. Under the comfortable settee berths, there are drawers for clothes. Shelves, cupboards, wardrobe, lockers, refrigerator or ice-box for food—there's a place for everything.

There's an efficient gas cooker in the shining galley, a modern sink and running hot and cold water (except Cadets). A flushing W.C. is provided and electric light throughout; For meals there is a dining nook or a folding table for the saloon. The comfortable settee seats either side make up at night into proper beds.

What about the navigator? According to the craft you choose, the controls may be forward, amidships, or in the cockpit aft. Whatever the layout, it gives you a feeling of confident control over your handsome craft. When it's necessary, there's complete weather protection by windscreen and canopy, car-type hood or fully retractable wheelhouse. Any of them can be raised or lowered in a few seconds.

Only the best marine engines are installed, giving a choice of petrol or diesel. Most craft also employ such refinements as oil operated gear-box and single lever control. Others are reduction geared for improved performance and fuel economy. Steering wheel and throttle are the main controls. The simple clutch-gear lever has just 3 positions: forward, neutral and reverse. All engines are, of course, fitted with self-starters to which they respond easily and immediately.

You are entirely independent of wind, weather and other people. You can go anywhere in the 200 cruising miles of beautiful Broads waterways, rivers and lakes. You can swing your craft round easily in her own length. You can moor beside a riverside inn, in a snug staithe, at a convenient yacht station inland or near the sea, in the wilds against the reeds, or you can drop anchor in the middle of a peaceful stretch of water away from everyone. Everywhere, you are aboard this wonderfully well-equipped craft which is all your own.

To complete your holiday enjoyment the following can be hired for a modest additional charge (see terms sheet) with each craft:—

Television

Radio

Sailing Dinghy

Rowing Dinghy

Folding mattress with extra bedding for additional person

8

BERTH



6

BERTH



6

BERTH



ADMIRAL CLASS No's 3, 4, 5, 6 & 7 (Diesel)

LENGTH: 42 ft. BEAM: 10 ft. 6 ins. HEADROOM: 6 ft. 3 ins. ENGINE: B.M.C. 4-cylinder diesel with reduction gear for best performance at lowest cost. GALLEY: Household type multi-burner gas cooker with grill and oven. Stainless steel sink and drain board unit with plenty of locker space. Galley conveniently placed aft, next to saloon. Instant hot water throughout. Refrigerator. BERTHS: Six single and one double. All Dunlopillo. SPECIAL FEATURES: Distinctive design with large parties or families in mind. Five entirely separate cabins, two toilet compartments supplied via Bee electric taps from 140-gallon tanks. 230-volt electric razor point. Wide safe decks fitted with non-slip pyramid rubber. Electric bilge pump. Easily operated wheel-house adaptable for all weather conditions. Windscreen wiper and upholstered helmsman's seat. Unique system of hot water supply to all basins and sink, heated by engine, remains hot for 24 hours.

ADMIRAL 5, 6 and 7 have an extra cockpit aft (see plan) and ADMIRAL 3 and 4 have proportionately larger centre cockpits.

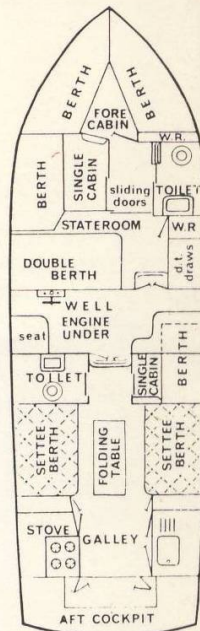
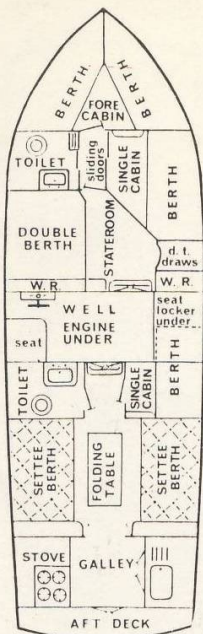

COMMODORE (Diesel)

LENGTH: 34 ft. 6 ins. BEAM: 10 ft. 6 ins. HEADROOM: 6 ft. 2 ins. ENGINE: 4-cylinder Mizar diesel with Borg Warner gear box. Single lever control. Exceptionally quiet and economical. GALLEY: Well planned Formica lined area adjacent but separate to saloon. Multi-burner household type cooker with grill and oven. Stainless steel sink. Large electric refrigerator. Hot and cold water from domestic type taps. BERTHS: Four single and one double 5 in. Dunlopillo.

SPECIAL FEATURES: Very latest design of cruiser giving maximum comfort for 6 persons. Large windows. Sliding wheelhouse forms spacious open deck saloon or cosy enclosed cabin. Hot water heated by engine remains hot for 24 hours. Shower bath. 240 volt razor point. Windscreen wiper. Upholstered helmsman's seat.

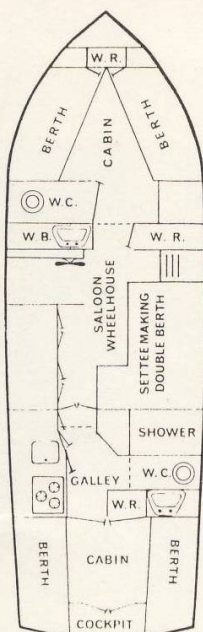

MARINER CLASS 1 & 2 (Diesel)

LENGTH: 38 ft. BEAM: 10 ft. 6 in. HEADROOM: 6 ft. ENGINE: 4-cylinder Leyland diesel with hydraulic gearbox and single lever control. A quiet and very economical unit. Alternator for rapid battery charging. GALLEY: Spacious compartment situated aft next to the saloon. Stainless steel sink. Multi-burner household cooker with oven and grill. Large electric refrigerator with ice cube/frozen food compartment. Hot water supply. BERTHS: Four single, one double 5 in. latex foam.

SPECIAL FEATURES: Beautifully appointed craft incorporating all the best ideas of our fleet. Special lowering wheelhouse which can have the top or sides up to suit all weather conditions. Separate Formica lined shower compartment as well as two toilets. Generous shelf, locker and wardrobe space. Hot water throughout (heated by engine) remains hot overnight. Razor point. Large windows giving a bright interior. Wide non-slip decks.



6

BERTH



5

BERTH

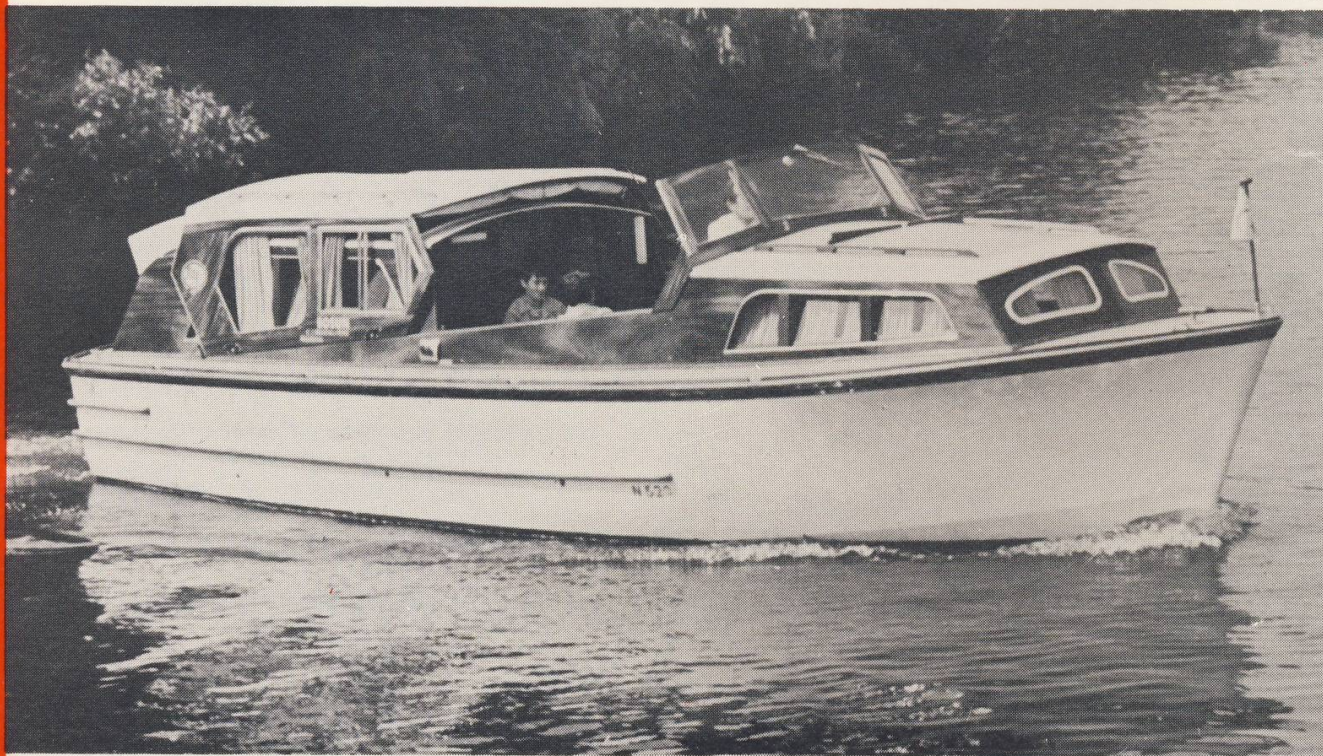

5

BERTH



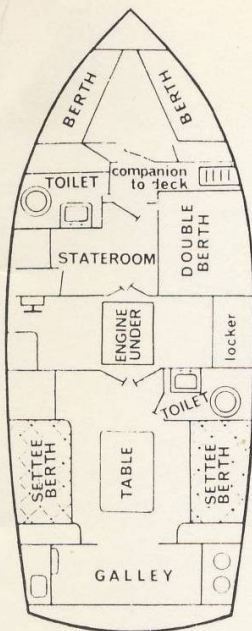

COMMANDER CLASS NO's 1, 2 (Diesel)

LENGTH: 37 ft. BEAM: 10 ft. 6 ins. HEADROOM: 6 ft. ENGINE: B.M.C. 4-cylinder diesel with reduction gear for improved performance. GALLEY: Household type multi-burner gas cooker with grill and oven. Stainless steel sink drainboard unit with lockers. All conveniently placed with plenty of space and headroom. Constant hot water supplied by heater. Large electric refrigerator. BERTHS: 4 single and one double with Dunlopillo mattresses.

SPECIAL FEATURES: Superb craft of the well-known Broom distinctive design with wide safe deck right round boat. Three entirely separate cabins and two separate toilet compartments supplied via Bee electric taps from 140-gallon tanks. 230-volt electric razor point. Plenty of wardrobe, dressing table and shelf space. Special lowering wheelhouse, providing all round glass protection, can be used with either top of sides up to suit weather conditions. Fitted with windscreen wiper and upholstered helmsman's seat.

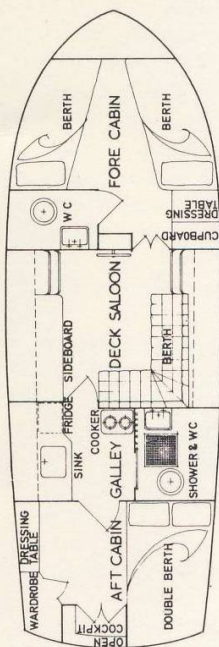

BOSUN (Diesel)

LENGTH: 30 ft. BEAM: 10 ft. 4 ins. HEADROOM: 6 ft. 1 in. ENGINE: Perkins diesel with 2 : 1 reduction gear for quiet economical running. Hydraulic gear box with single lever control. Alternator for rapid battery charging. GALLEY: Formica lined compartment situated conveniently next to deck saloon. Gas cooker with grill, oven and boiling rings. Stainless steel sink, hot water supply. Large electric refrigerator with ice cube/frozen food container. BERTHS: Three single and 1 double 5 in. latex foam bunks covered with easy to clean material.

SPECIAL FEATURES: A new luxury cruiser of outstanding design. All weather sliding wheelhouse top with inside control for single handed operation. The raised deck saloon gives wonderful visibility in complete comfort. Shower bath, two toilet compartments. Razor point. Clorifier heater for water remains hot over night. Wide safe decks. Introduced last year for the first time, this craft proved immediately popular and is now booked from year to year by some customers.

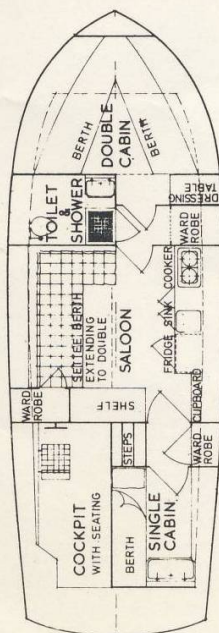

ENSIGN CLASS No's 1 & 2 (Diesel)

LENGTH: 30 ft. BEAM: 10 ft. 3 ins. HEADROOM: 6 ft. 1 in. ENGINE: Mizar diesel with Borg Warner gear box. Single lever control. Very economical. GALLEY: well planned with Formica and stainless steel decor. Household type gas cooker with grill and oven. Hot and cold water from domestic type taps. Electric refrigerator. BERTHS: Three single and one double 5 in. Dunlopillo covered with easy clean coverings.

SPECIAL FEATURES: Ultra modern all fibreglass cruiser incorporating the very latest ideas for a holiday cruiser. Unique layout gives three entirely separate cabins for five persons. Hot water heated by engine remains hot for 24 hours. Shower bath. 240-volt razor point. Windscreen wiper. Cockpit has easy folding car type hood and observation seat. Wide safe decks.

4

BERTH



4

BERTH

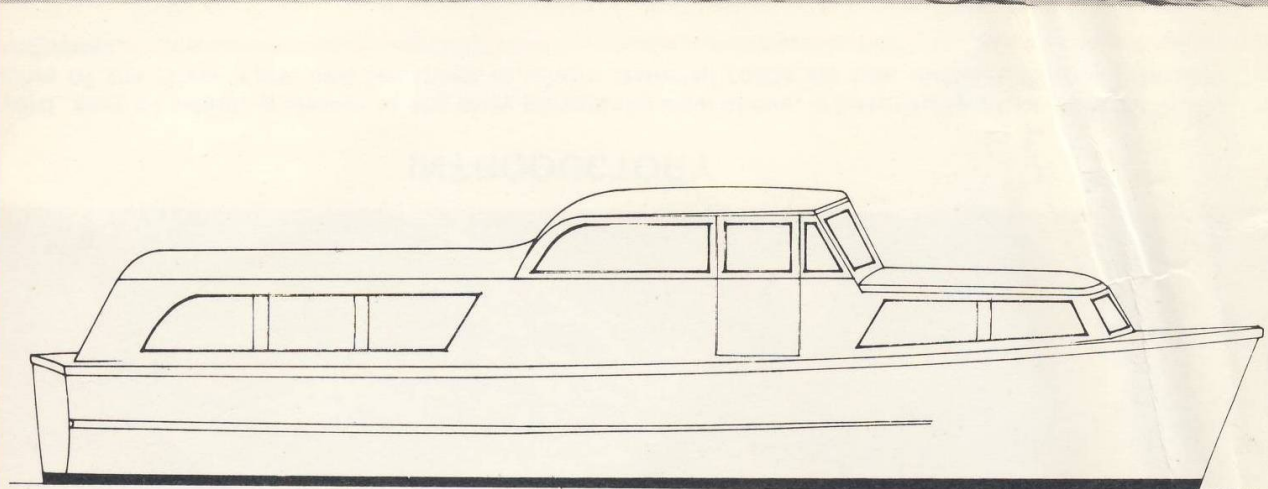

4

BERTH



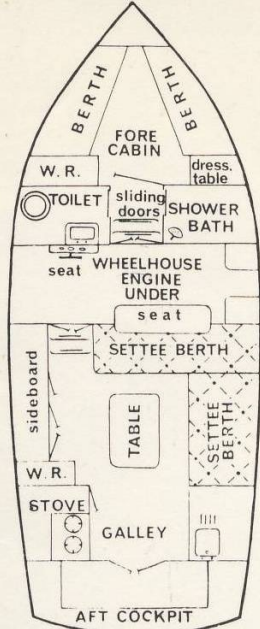

NAVIGATOR CLASS No's 1, 2, 3 & 4 (Diesel)

LENGTH: 35 ft. BEAM: 10 ft. 3 ins. HEADROOM: 6 ft. minimum. ENGINE: No's 1 & 2 B.M.C. diesel, No's 3 & 4 Altair diesel, all reduction geared. Single lever control. Automatic gearbox. GALLEY: Large and plastic-lined, adjoining saloon, opening to aft cockpit. Large gas cooker, grill and oven. Refrigerator. Stainless steel sink. BERTHS: Four single 5 in. Dunlopillo.

SPECIAL FEATURES: Modern craft of the well known Broom distinctive design. Electric flushing W.C. Shower bath. Electric water taps, hot and cold. 230-volt razor point. Wheelhouse with glass sides, Vyanide roof. Windscreen wiper. Upholstered helmsman's seat, and special high level upholstered seat for passengers. Wide, non-slip decks. These craft incorporate the very latest in four berth design.

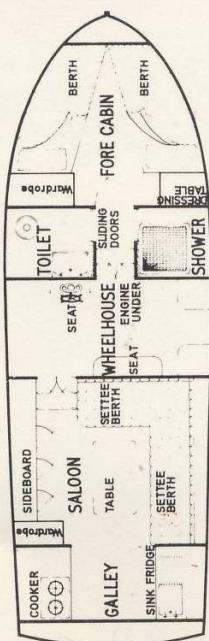

SKIPPER CLASS 1, 2, 3 & 4 (Diesel)

LENGTH: 30 ft. BEAM: 10 ft. 4 ins. HEADROOM: 6 ft. 1 in. ENGINE: Perkins diesel with 2 : 1 reduction gear for smooth economical running. Alternator for rapid battery charging. Single lever control. GALLEY: Formica lined compartment situated aft adjacent to saloon. Household gas cooker with oven, grill and three burners. Stainless steel sink. Hot water supply. Large electric refrigerator with ice cube/frozen food container. Large opening windows. BERTHS: 4 single 5 in. latex foam covered with easy to clean vinyl.

SPECIAL FEATURES: The latest addition to our fleet, the Skipper, incorporates 60 years of experience of designing and building Broads hire cruisers. Spacious, bright interior with modern decor. Separate toilet and shower compartments. Pressurised hot and cold water heated by engine keeps hot 24 hours. Razor point. Wheelhouse has folding down windscreen and sidescreens and roll back roof, making wonderful suntrap. Special raised upholstered seat in cockpit for 3 persons.

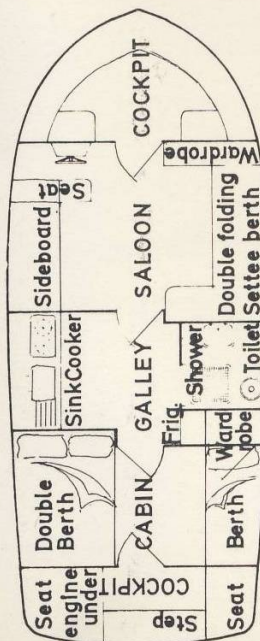

CRUISELINER CLASS 1, 2 & 3 (Diesel)

LENGTH: 30 ft. BEAM: 10 ft. 6 ins. HEADROOM: 6 ft. 2 ins. ENGINE: Perkins diesel with latest hydraulic drive, eliminating propeller shaft. Engine outside in aft cockpit gives exceptionally quiet running. Single lever control. Alternator for rapid battery charging. Very economical. GALLEY: Well planned adjacent to sun lounge/dining area. Formica lined with stainless steel sink and modern kitchen unit. Large electric refrigerator with ice cube/frozen food container. Ample locker space. Hot water supply. Household cooker with oven, grill and three boiling rings. BERTHS: 2 double and 1 single. 5 in. latex foam covered in easy to clean vinyl. (A fifth person can be accommodated at standard extra charge).

SPECIAL FEATURES: Ultra modern all fibreglass cruiser of the very latest design. The location of the engine outside in the aft cockpit enables a level floor throughout. Large windows. The whole roof of the forward compartment slides back to make a wonderful sun trap. There is access each end from the two sheltered, self draining cockpits (each with seats). Forward driving position with special interior windows giving visibility through boat. Shower bath. Pressurised hot and cold water system. Razor point. Wide safe decks. A joy to handle regardless of weather. This craft has all the amenities of a modern flat.

4

BERTH



4

BERTH



4

BERTH



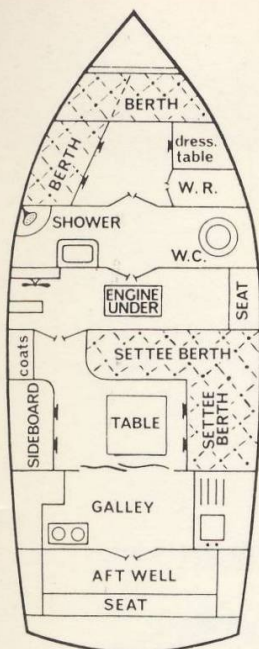

MIDSHIPMAN CLASS No's 1 & 2 (Diesel)

LENGTH: 34 ft. 6 ins. BEAM: 10 ft. 3 ins. HEADROOM: 6 ft. 2 ins. ENGINE: Marine diesel. Very economical. BERTHS: Four single with Dunlopillo mattresses. GALLEY: Large, well-lit compartment between saloon and aft cockpit. Household type gas cooker with grill and oven. Hot and cold water. Stainless steel sink. Refrigerator.

SPECIAL FEATURES: Spacious, beautifully appointed craft of the well proven Broom design. Large windows. Hot water supplied throughout, heated by engine, remains hot for 24 hours. 230-volt A.C. shaver point. Shower bath with teak grating. Wide, safe decks. Easily operated canopy and windscreen gives complete protection.

The aft cockpit is an important feature of this design, providing an extension to the galley in good weather, extra storage space and a wonderful place to fish from or to enjoy the ever changing scene of Broadland.

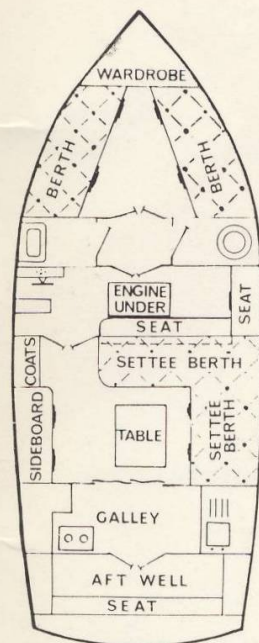

LIEUTENANT (Diesel)

LENGTH: 35 ft. BEAM: 10 ft. 3 ins. HEADROOM: 6 ft. minimum. ENGINE: B.M.C. diesel with 2 : 1 reduction gear very economical. BERTHS: Four single berths with Dunlopillo mattresses. GALLEY: Extra large compartment right aft adjoining saloon and opening out directly on to open cockpit. Household type multi-burner gas cooker with grill and oven. Stainless steel sink and draining board with generous locker space. Instant hot water from special heater. Large refrigerator.

SPECIAL FEATURES: A modern craft of distinctive appearance with beautifully appointed interior. Sink and wash-basin supplied via Bee electric taps from 130-gallon tank. Wash-basin and W.C. in separate compartments with hot and cold water. Generous wardrobe and hanging space. 230-volt electric razor point. Easily operated canopy with special side screens and windscreen wiper. Upholstered helmsman's seat. This craft is in a class alone, providing that little extra in comfort and accommodation for the more discerning customer.

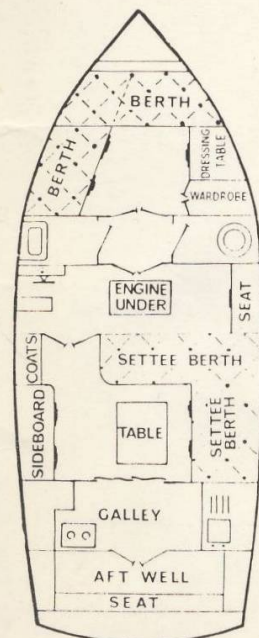

CAPTAIN CLASS No's 7, 8, 9, 10 & 12 (Diesel)

LENGTH: 34 ft. 6 ins. BEAM: 10 ft. 3 ins. HEADROOM: 6 ft. minimum. ENGINE: CAPTAIN 7, 10 and 12 - B.M.C. diesel, No's 8 and 9 - Altair diesel, with single lever control. BERTHS: Four single berths with Dunlopillo mattresses. GALLEY: Extra large compartment right aft adjoining saloon and opening out directly on to open cockpit. Household type two-burner gas cooker with grill and oven. Stainless steel sink and draining board with generous locker space. Instant hot water from special heater. Refrigerator.

SPECIAL FEATURES: Superb craft of the well known Broom distinctive design with accent on roominess and comfort. Sink and wash-basin supplied via Bee electric taps from 130-gallon tank. Wash-basin and W.C. in separate compartments. Generous wardrobe and hanging space. 230-volt electric razor point. Easily operated canopy with fitted awnings and windscreen wiper. Upholstered helmsman's seat.

CAPTAIN 10 has white enamelled hull, as illustrated: the others are bright varnished. The CAPTAIN class has proved to be one of the most successful cruisers ever designed for Broadland cruising, having been copied many times but never bettered.

4

BERTH



4

BERTH

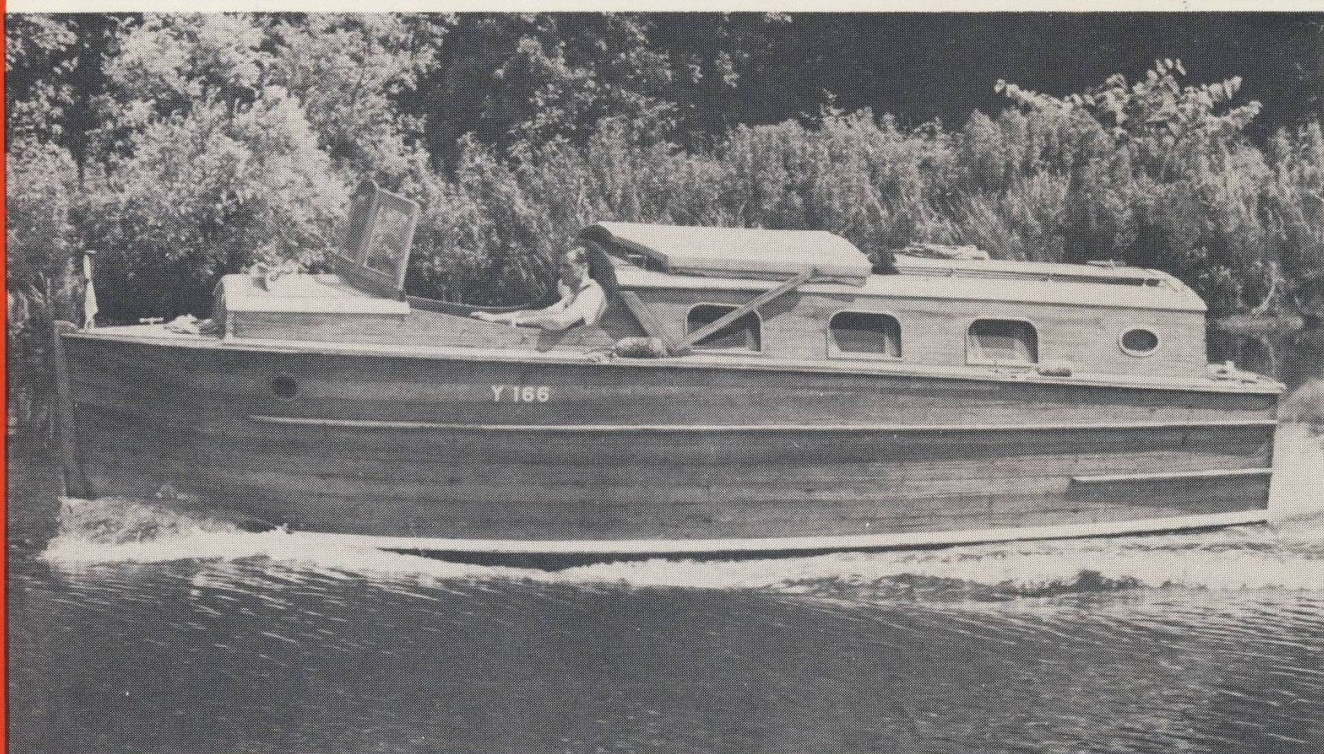

2

BERTH

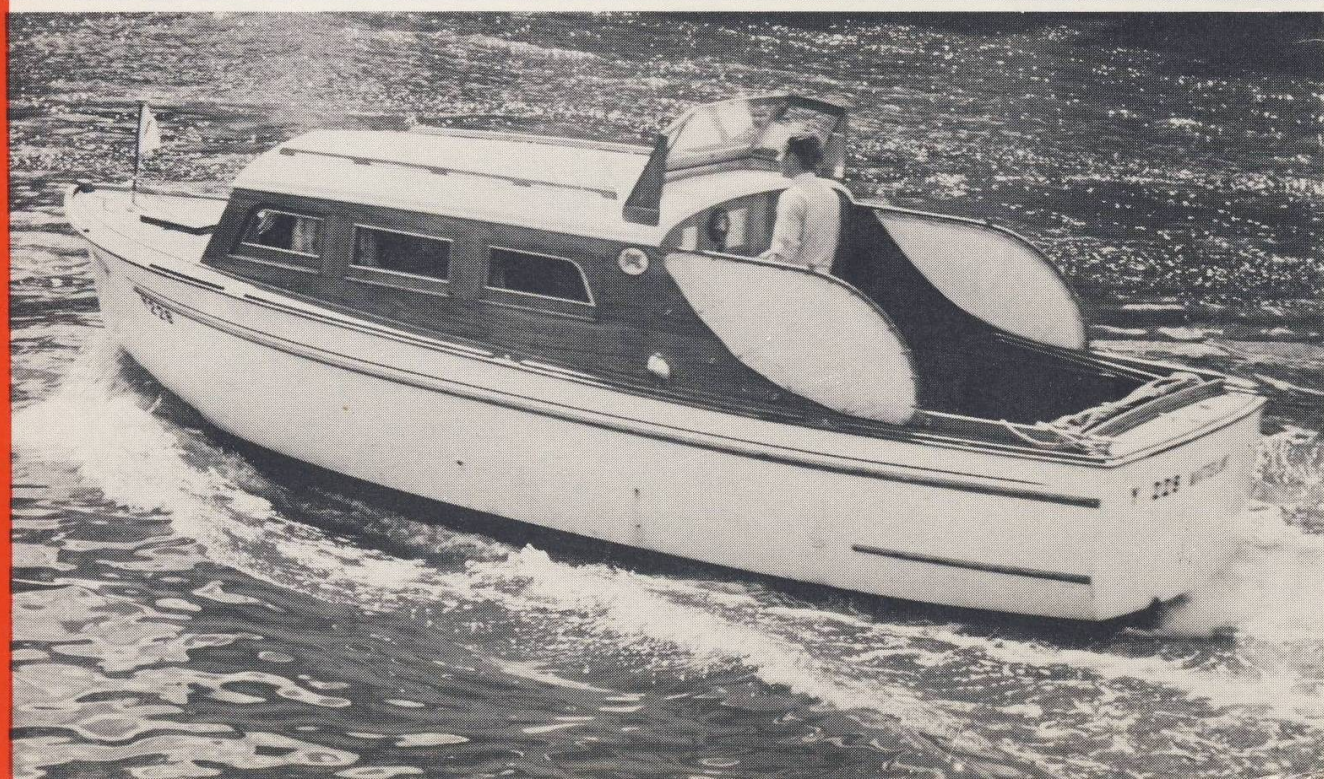

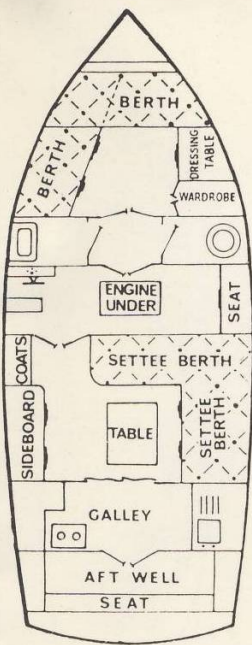

CAPTAIN BLIGH (Diesel)

CAPTAIN COOK CLASS (Petrol)

CAPTAIN COOK, CAPTAIN VOSS and CAPTAIN KIDD

LENGTH: 30 ft. 6 ins. BEAM: 10 ft. 3 ins. HEADROOM: 6 ft. minimum. ENGINE: COOK Class 20 h.p. petrol unit. This provides unusually quiet running. CAPTAIN BLIGH - diesel engine with single lever control. BERTHS: Four single berths with Dunlopillo mattresses. GALLEY: Extra large compartment right aft adjoining saloon and opening out directly on to open cockpit. Household type multi-burner gas cooker with grill and oven. Stainless steel sink and draining board with generous locker space. Instant hot water from special heater. Ice-box.

SPECIAL FEATURES: Superb craft of the well-known Broom distinctive design with accent on roominess and comfort. Sink and wash-basin supplied via Bee electric taps from 130-gallon tank. Wash basin and W.C. in separate compartments. Generous wardrobe and hanging space. 230-volt electric razor point. Wheelhouse has glass fold down sides and windscreen with easy roll back hood. Sides can be used in up position with hood down to give excellent protection from wind. Upholstered raised up passengers seat in wheelhouse. Upholstered helmsman's seat. Wide safe non-slip decks.

These craft, with their beautifully panelled interior, represent all that is best in craftsmanship and comfort.

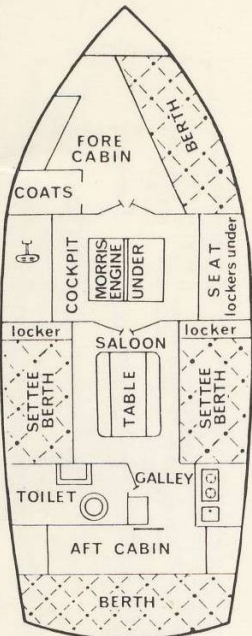

CADET CLASS No's 7 & 8 (Petrol)

LENGTH: 25 ft. BEAM: 8 ft. 6 ins. HEADROOM: 6 ft. ENGINE: 4-cylinder B.M.C. Vedette. GALLEY: Formica lined. Two-burner gas cooker with oven. Sink, draining board and lockers. Ice-box. BERTHS: Four singles with Dunlopillo mattresses in two single and one double cabins.

SPECIAL FEATURES: Designed with careful consideration for mixed parties and achieved by a three separate cabin arrangement. Fore and aft single cabins fitted with small dressing tables. Trakmark non-slip decks. Upholstered driving seat. 230-volt shaver point. Very light, easily operated canopy with fitted awnings and windscreen with wiper. These craft are very manoeuvrable, economical and easy to handle.

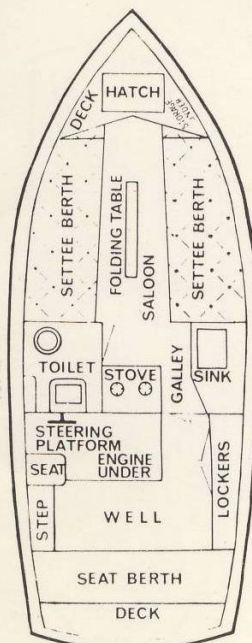

MATELOT (Petrol)

LENGTH: 25 ft. BEAM: 8 ft. 6 ins. HEADROOM: 6 ft. 2 ins. ENGINE: 4-cylinder B.M.C. Navigator with single lever control and latest hydraulic gearbox. GALLEY: Two-burner gas stove with oven. Stainless steel sink and drainboard. Water heater. Ice-box. BERTHS: Two Dunlopillo with upholstered back-rests. A third person can be accommodated in the cockpit at the standard extra charge.

SPECIAL FEATURES: A distinctive luxury cruiser with large comfortable aft cockpit. Upholstered helmsman's seat. Folding car type hood. Windscreen wiper, 230-volt electric razor point. Electric Bee taps supply hot water to sink and basin. Being slightly larger than average for a two berth, this craft provides a high degree of comfort and is one of the most popular 2 berth cruisers available on the Broads. Very manoeuvrable and easy to handle.

CONDITIONS OF HIRE

A deposit of £2 per person per week for the full number of persons advertised for the chosen craft must be paid by the Hirer at the time of booking. The deposit is part payment of the hire charge. Only the complete boat can be booked, not separate single places.

The Hirer is responsible for the balance of hire money for the craft and not for the deposit only. The balance is due and payable to the Owner of the craft at the place of embarkation on the date given for commencing the cruise and must be paid before starting.

If the party cannot take possession, the Hirer must notify the owner immediately and return the hire invoice. The deposit is then forfeited. If notice of cancellation, always required in writing, is not given or is received less than four weeks prior to the departure date the Hirer will remain responsible for the whole of the hire balance due to the owner if the boat is not re-let. (A special low cost Holiday Protection Insurance is available through the Owner effected with Lloyds Underwriters which will protect the hirer and each member of his party against the cancellations or curtailment charges, including deposit, due to death, injury or illness of an insured person or close relative up to a maximum of £25 loss of luggage up to £125 including personal money up to £25 and Personal Accident £1,000 maximum. These benefits are per person insured, and the inclusive premium for the holiday period is £2 for a party up to 3 persons on one boat or £3 for 4 persons or more on one boat. This protection has been designed with the needs of the Norfolk Broads holidaymaker in mind and the Owner recommends that Hirers and members of the party should take advantage of it at the time of booking and include the premium with the booking deposit. The party names must be given and it is the responsibility of the Hirer to advise the Owner before the holiday commences if there is any change in the persons' names).

The hire terms quoted are based on costs in force at the time but are subject to revision in the event of any fluctuation in these costs.

The hirer is responsible for the craft, all equipment aboard during the period of hire, for the clean condition of all utensils at the end of the hire and for taking all responsible care. Insurance of craft against accident is included in the terms, but the hirer has to pay a security deposit of £5 at the boatyard on taking over the boat. This security deposit will be refunded on the return to the boatyard if there has been no damage or loss. All craft are let unattended. The letting is made on the understanding that the boat is to be placed at the disposal of the hirer on the date in question unless the Owner is prevented from so doing by circumstances but under the control of the owner, in which case the deposit shall be returned to the Hirer in full, but the Hirer shall have no claim on any account against the Owner.

Advance bookings for extras such as dinghies, T.V. and radio are subject to final availability on the date required.

The correct time to join craft is 4 p.m. All craft must be given up by 10 a.m. at the Owner's yard from which the cruise commenced.

Motor craft are let on the understanding that the Owner will give the Hirer a trial run to show that the engine is in good order, after which the Hirer must take all responsibility. Upon taking over, the Hirer pays for the boat's tank full of fuel, and engine oil, cash refund being given for surplus at the end of cruise.

Minors, Hirers under 21 years of age must state that they are minors and send the written consent of parent or guardian when booking craft. The parent or guardian in giving written consent must confirm acceptance of obligations under the Booking Conditions and responsibility for the hire money. Only the person booking the craft need do this - not the whole party.

Navigation: under no circumstances may Broads craft be taken out to sea or below Southtown Bridge, Great Yarmouth, or through the lock at Oulton Broad. Cruising after dark is not permitted. The Owners written consent to race any craft must be obtained in advance.

The starting and finishing point for craft is Brundall, unless different arrangements are agreed upon by us. PETS are not allowed on craft without prior notice.

LIFE JACKETS are obtainable free on loan and all non-swimmers are urged to wear these.

GARAGE accommodation is available at reasonable charges.

**AS WE ARE CONTINUALLY IMPROVING OUR FLEET, WE RESERVE
THE RIGHT TO VARY THESE SPECIFICATIONS WITHOUT PRIOR NOTICE**

Booking Form

To Messrs. C. J. BROOM & SONS,
Boat Builders,
Brundall, Norfolk NOR 862

Please book me craft.....

period from..... to.....

In the event of the above-named Craft or period being already engaged, you may book me one of the following in order given :—

1 Craft..... Period.....

2 Craft..... Period.....

3 Craft..... Period.....

I enclose cheque/order/cash for :—

Deposit (being part payment of hire charge) £ : :

Holiday Protection Insurance Premium £ : :

Total £

Have you studied
the Holiday
Protection Insurance

I am over 21 years of age and I agree to be held responsible for the balance which becomes due to and payable to the owner at place of embarkation on date mentioned for commencing cruise, as per condition in catalogue.

Signature.....

Name in Capitals.....

Address.....

Date..... Telephone.....

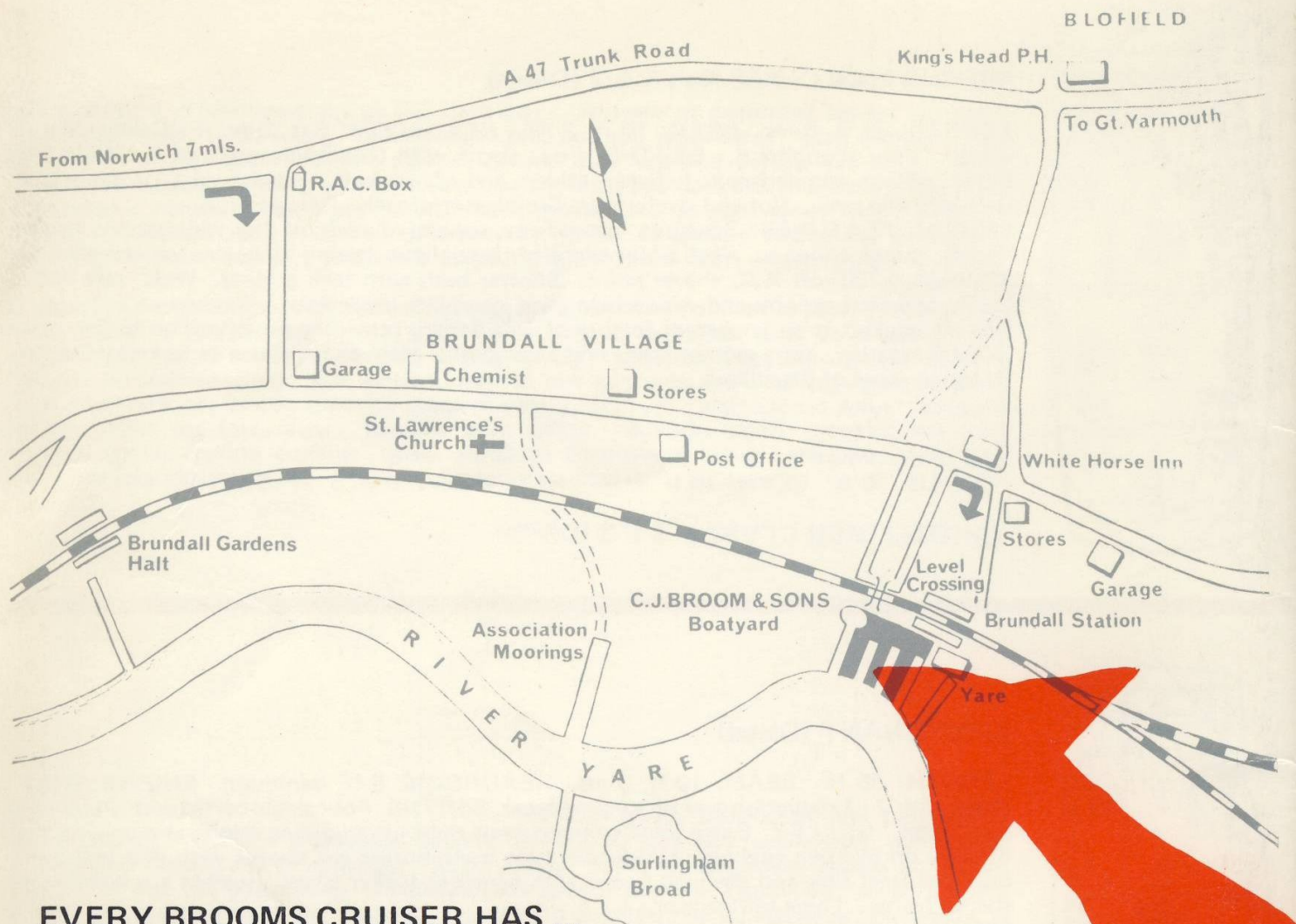

EVERY BROOMS CRUISER HAS ...

- 1 Engine fitted with electric self-starter and reverse gear.
- 2 Sleeping berths at least 6 ft. in length.
- 3 Complete all-weather protection; collapsible canopy or awning cover for cockpit well. Windscreen wiper.
- 4 Gas cooking. See individual craft specifications for type of cooker. Calor gas included in terms.
- 5 Electric lighting.
- 6 Full complement of blankets, pillows and/or cushions, sheets, pillow-slips, table and tea-cloths, cutlery, crockery and cooking equipment. (Not Towels).
- 7 Ample storage room (shelves, drawers, cupboards, lockers) for your personal belongings and provisions.
- 8 Pump flushing W.C.
- 9 Fresh water storage tanks.
- 10 Ice-box or Refrigerator.
- 11 Folding table.
- 12 Helmsman's seat.
- 13 Deck gear inclusive of mooring ropes with rond anchors, boat-hook, dropping weight, fendoffs and deck mop.
- 14 240-volt electric razor point.

Boat plans simply show accommodation and are not to scale.



THE SYMBOL OF ALL THAT'S BEST ON THE BROADS